

## Cock For Pressure Gauges [CPG]

DN 15 ÷ DN 20  
PN 16 ÷ PN 160

### Applications

- For general use with water, steam and other non-aggressive fluids.

### Materials:

- Body is from forged steel
- Plug is made of stainless steel
- Plug packing is made of compressed graphite

### Production and delivery:

- By turning the lever we may achieve the proper joint of connection in all combinations, as well as the position of closed all connections.
- Basic use is with gauge connection and relief lines. In standard feature the connections are with inside thread Rp 1/2".

### Options

- Cocks with connections according to customer requirements
- Cocks made of material suitable for the fluid features

### Installation instructions:

- Before installation and first run, the connecting pipeline should be thoroughly cleaned of all impurities and extraneous materials
- By first run, suitable for need, tighten the plug packing until the proper sealing is achieved

### Testing

- Every produced cock was tested according to EN 12266

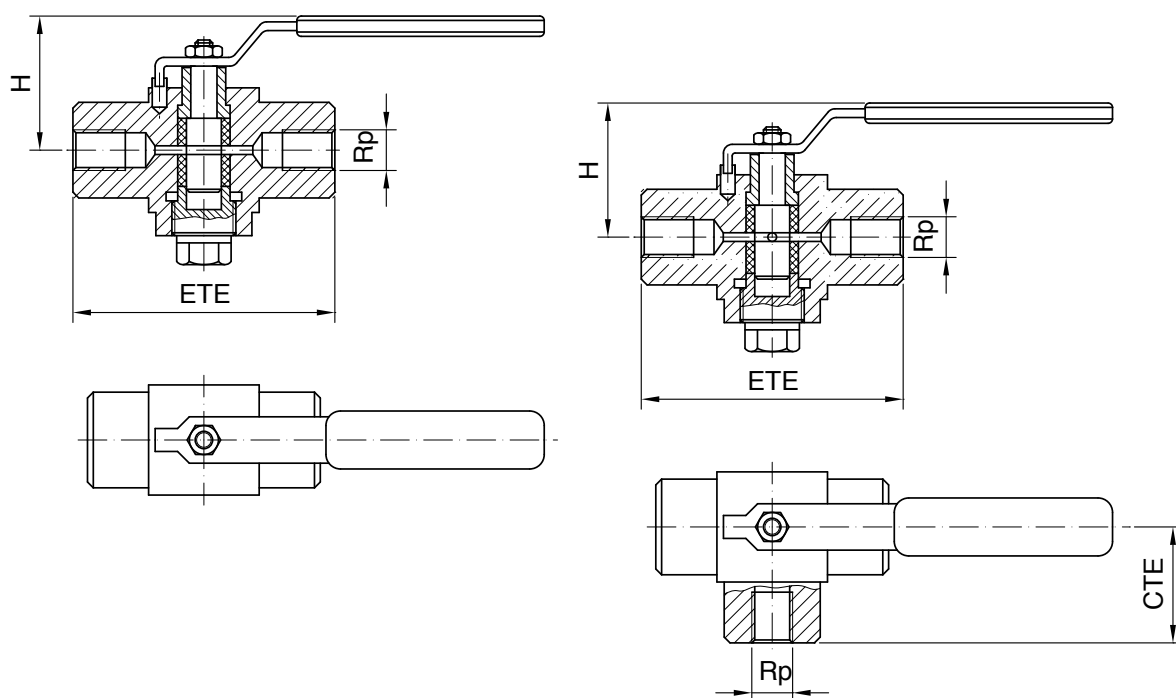

Drawing E.1.1 Dimensions

[CPG] Dimensions

Table E.1.1

DN	Rp	ETE	CTE	H	(kg)
		(mm)			
15	1/2"	85	42,5	53	0,7
20	3/4"	90	42,5	58	0,8